

DEPARTMENT OF ENVIRONMENTAL QUALITY

WATER RESOURCES DIVISION

GREAT LAKES BOTTOMLANDS PRESERVES

(By authority conferred on the director of the department of environmental quality by section 76111 of 1994 PA 451, MCL 324.76111 and Executive Reorganization Order Numbers 1995-16, MCL 324.99903, 2009-31, MCL 324.99919 and 2011-1, MCL 324.99921)

R 299.6001 Thunder Bay Great Lakes state bottomland preserve; establishment.

Rule 1. The following described area is established as the Thunder Bay Great Lakes state bottomland preserve: That area of Lake Huron bottomlands, extending upward and including the surface of the water, within the latitudes 44°52'50" (South Point) and 45°11'24" (Middle Island) and lying between the ordinary high shoreline and the 150-foot depth contour based on the ordinary high-water level, Alpena county, Michigan, which area contains 288 square miles, more or less.

History: 1981 AACS.

R 299.6002 Alger Great Lakes state bottomland preserve; establishment.

Rule 2. The following described area is established as the Alger Great Lakes state bottomland preserve: That area of Lake Superior bottomlands, extending upward and including the surface of the water, within the longitudes 86°08'30" (AuSable Point) and 86°47'30" (AuTrain Point) and lying between the ordinary high shoreline and the 150-foot depth contour as intersected by said longitudes and based on the ordinary high-water level, including depressions in excess of 150 feet within the aforementioned area, Alger county, Michigan, which area contains 113 square miles, more or less.

History: 1981 AACS.

R 299.6003 Straits of Mackinac Great Lakes state bottomland preserve; establishment.

Rule 3. The following described area is established as the Straits of Mackinac Great Lakes state bottomland preserve: That area of bottomlands of the Straits of Mackinac which connect Lake Michigan and Lake Huron, extending upward and including the surface of the water with a western boundary beginning at the longitude 84 degrees 56'22"W on the south shore, an official NOAA triangulation point located in Emmett county about 1/2 mile east of station point cabin on NOAA chart 14881, extending northward to St. Helena shoal buoy, 84 degrees 55'21"W, and then

generally northeastward to the north shore at a point where the dividing line between sections 5 and 8, T40N, R4W, of Mackinac county intersects the ordinary high-water mark. The eastern boundary shall be a line running directly north and south at longitude 84 degrees 30'W between Bois Blanc Island and the southern peninsula (Cheboygan county). The northern boundary shall begin at the place where the western boundary strikes the northern peninsula and extend generally eastward along the ordinary high-water mark, to a point north of St. Ignace where the dividing line between sections 6 and 7, T40N, R4W, of Mackinac county intersects the ordinary high-water mark, approximately 45 degrees 52'54"N latitude, and then directly true eastward to Mackinac Island. The boundary then moves generally south and eastward along the ordinary high-water mark of the south side of Mackinac Island until it reaches the southern tip of the east breakwall extending outward from Mission point to Mackinac Island. The northern boundary then extends in a southwesterly direction from the tip of the breakwall to the abandoned lighthouse on the west end of Round Island and then along the ordinary high-water mark of the western shore of Round Island and then along the ordinary high-water mark of the southern shore of Round Island to the point of land at the southeastern tip of Round Island. The northern boundary extends from this point across to Lime Kiln Point on Bois Blanc Island and then along the ordinary high-water mark of the southern shore until it intersects the eastern boundary at 84 degrees 30'W longitude. The southern boundary shall start at the intersection of the western boundary with the southern peninsula, 84 degrees 56'22"W longitude, and extends generally eastward along the ordinary high-water mark to a point where the eastern boundary intersects the southern peninsula, 84 degrees 30'W longitude, Cheboygan, Emmet, and Mackinac counties, Michigan, which area contains 148 square miles, more or less.

History: 1983 AACS.

R 299.6004 Thumb Area Great Lakes state bottomland preserve; establishment.

Rule 4. The following described area is established as the Thumb Area Great Lakes state bottomland preserve: That area of bottomlands of Lake Huron, extending upward and including the surface of the water with a western boundary beginning at the light on the end of the breakwater in Port Austin, thence extending northerly along Loran-C coordinate 8970-X-30910; thence easterly along Loran-C coordinate 8970-Y-49150; thence southerly along Loran-C coordinate 8970-X-30730; thence westerly along Loran-C coordinate 8970-Y-49335.5 to the south boundary of Wagener County Park, thence northerly and westerly along the ordinary high water mark to the point of beginning, which area contains 276 square miles, more or less.

History: 1985 AACS.

R 299.6005 Whitefish Point Great Lakes state bottomland preserve; establishment.

Rule 5. The following described area is established as the Whitefish Point Great Lakes state bottomland preserve: An area of Lake Superior bottomlands extending upward and including the water surface described as: Beginning at the mouth of the outlet of Little Lake in section 24, township 50 north, range 9 west, Luce County, Michigan; thence northerly to Loran-C coordinates 8970-Y-47450, 8970-X-31230; thence easterly to a point where Loran-C coordinate line 8970-Y-47530 intersects the international boundary between Canada and the United States; thence southeasterly along the international boundary to a point having a latitude of 46 degrees, 53 minutes, 20.668 seconds and longitude of 84 degrees, 51 minutes, 35.830 seconds; thence continuing southeasterly along the international boundary to a point having latitude 46 degrees, 38 minutes, 4.030 seconds and longitude 84 degrees, 45 minutes, 45.512 seconds; thence continuing along the international boundary to its intersection with Loran-C coordinate line 8970-Y-47740; thence northwesterly to the mouth of the Betsy River in section 2, township 49 north, range 6 west, Chippewa County, Michigan; thence northerly and westerly along the ordinary high watermark of Lake Superior to the point of beginning at the mouth of the outlet of Little Lake, containing 376 square miles more or less.

History: 1987 AACCS.

R 299.6006 Sanilac Shores Great Lakes state bottomland preserve; establishment.

Rule 6. The following described area is established as the Sanilac Shores Great Lakes state bottomland preserve: An area of Lake Huron bottomlands extending upward and including the water surface described as: Beginning at the point where the east and west 1/4 line of section 29, township 14 north, range 16 east, Sanilac County, Michigan, intersects the ordinary high watermark of Lake Huron, thence easterly to Loran-C coordinates 8970-X-30760, 8970-Y-49400; thence southerly to Loran-C coordinates 8970-X-30760, 8970-Y-49480; thence southerly to Loran-C coordinates 8970-X-30780, 8970-Y-49540; thence southwesterly to Loran-C coordinates 8970-X-30830, 8970-Y-49576; thence westerly to where the south line of section 31, township 10 north, range 17 east, Sanilac County, Michigan, intersects the ordinary high watermark of Lake Huron, thence northerly along the ordinary high watermark of Lake Huron to the point of beginning at the east and west 1/4 line of section 29, township 14 north, range 16 east, containing 163 square miles, more or less.

History: 1988 AACCS.

R 299.6007 Manitou Passage Great Lakes state bottomland preserve; establishment.

Rule 7. The following described area is established as the Manitou Passage Great Lakes state bottomland preserve: An area of Lake Michigan bottomlands extending upward and including the water surface described as: Beginning at a point where the west line of township 27 north, range 15 west, Benzie County, intersects the ordinary

high waterline (elevation 579.8 I.G.L.D.) of Lake Michigan (approximate latitude 44 degrees 43 minutes 09 seconds and longitude 86 degrees 10 minutes 54 seconds); thence northwesterly to a point having latitude 45 degrees 00 minutes and longitude 86 degrees 15 minutes; thence northeasterly to a point having latitude 45 degrees 11 minutes and longitude 86 degrees 05 minutes; thence due east to a point having latitude 45 degrees 11 minutes and longitude 86 degrees 00 minutes; thence southeasterly to a point having a latitude of 45 degrees 07 minutes 30 seconds and longitude 85 degrees 57 minutes; thence southerly to the North Manitou Shoal Light Horn (approximate latitude 45 degrees 01 minutes 15 seconds and longitude 85 degrees 57 minutes 25 seconds); thence southeasterly to where the north line of township 29 north, range 12 west, Leelanau County, intersects the ordinary high waterline of Lake Michigan (approximate latitude 44 degrees 57 minutes 11 seconds and longitude 85 degrees 48 minutes 14 seconds); thence westerly and southerly along the ordinary high waterline of Lake Michigan to the point of beginning, excluding the areas of North and South Manitou Islands above the ordinary high waterline of Lake Michigan, containing 282 square miles, more or less.

History: 1988 AACCS.

R 299.6008 Marquette Great Lakes state bottomland preserve; establishment.

Rule 8. (1) The following described area is established as the Marquette unit of the Marquette Great Lakes state bottomland preserve:

A 74-square mile area of Lake Superior bottomland extending upward and including the water surface described as: Beginning at the point where the line between range 25 west and range 26 west in township 49 north, Marquette County, Michigan, intersects the ordinary high waterline of Lake Superior (elevation 601.5 international Great Lakes datum 1955), approximate latitude 46 degrees 38 minutes 29 seconds north longitude 87 degrees 29 minutes 21 seconds west; thence northeasterly on a heading of 70 degrees a distance of 3.37 miles to the point at latitude 46 degrees 39.6 minutes north longitude 87 degrees 25.5 minutes west; thence southeasterly on a heading of 115 3/4 degrees a distance of 2.64 miles to the point at latitude 46 degrees 38.2 minutes north longitude 87 degrees 22.5 minutes west; thence southeasterly on a heading of 155 1/4 degrees a distance of 3.80 miles to the point at latitude 46 degrees 35.8 minutes north longitude 87 degrees 20.5 minutes west; thence southeasterly on a heading of 126 degrees a distance of 5.89 miles to the point at latitude 46 degrees 32.2 minutes north longitude 87 degrees 14.8 minutes west; thence northeasterly on a heading of 46 degrees a distance of 6.63 miles to the point at latitude 46 degrees 36.0 minutes north longitude 87 degrees 08.5 minutes west; thence southeasterly on a heading of 161 degrees a distance of 2.44 miles to the point at latitude 46 degrees 34.8 minutes north longitude 87 degrees 07.5 minutes west; thence southerly a distance of 5.76 miles to the point where the line between Marquette County and Alger County, Michigan, intersects the ordinary high waterline of Lake Superior, approximate latitude 46 degrees 29.7 minutes north longitude 87 degrees 07.0 minutes west; thence westerly, northerly, and

northwesterly along the ordinary high waterline to the point of beginning, excluding that part of all islands within the described parcel above the ordinary high waterline.

(2) The following described area is established as the Huron islands unit of the Marquette Great Lakes state bottomland preserve:

An 89-square mile area of Lake Superior bottomland extending upward and including the water surface described as: Beginning at the point where the line between Baraga County and Marquette County, Michigan, intersects the ordinary high waterline of Lake Superior (elevation 601.5 international Great Lakes datum 1955), approximately latitude 46 degrees 54.7 minutes north longitude 88 degrees 02.7 minutes west; thence due north a distance of 4.61 miles to the point at latitude 46 degrees 58.5 minutes north longitude 88 degrees 02.7 minutes west; thence due east a distance of 9.46 miles to the point at latitude 46 degrees 58.5 minutes north longitude 87 degrees 50 minutes west; thence southeasterly on a heading of 126 1/4 degrees a distance of 3.91 miles to the point at latitude 46 degrees 56.1 minutes north longitude 87 degrees 46.8 minutes west; thence southeasterly on a heading of 116 degrees a distance of 5.26 miles to the point at latitude 46 degrees 54.4 minutes north longitude 87 degrees 40.8 minutes west; thence due south a distance of 4.61 miles to a point on the ordinary high waterline of Lake Superior due north of the big bay point light, approximate latitude 46 degrees 50.5 minutes north longitude 87 degrees 40.8 minutes west; thence westerly, southerly, westerly, northerly, and northwesterly along said ordinary high waterline to the point of beginning, excluding that part of all islands within the described parcel above the ordinary high waterline.

(3) The Marquette unit and the Huron islands unit are illustrated in the following figures:

Figure 1
Marquette
Great Lakes State Bottomland Preserve
Marquette Unit
74 Square Miles

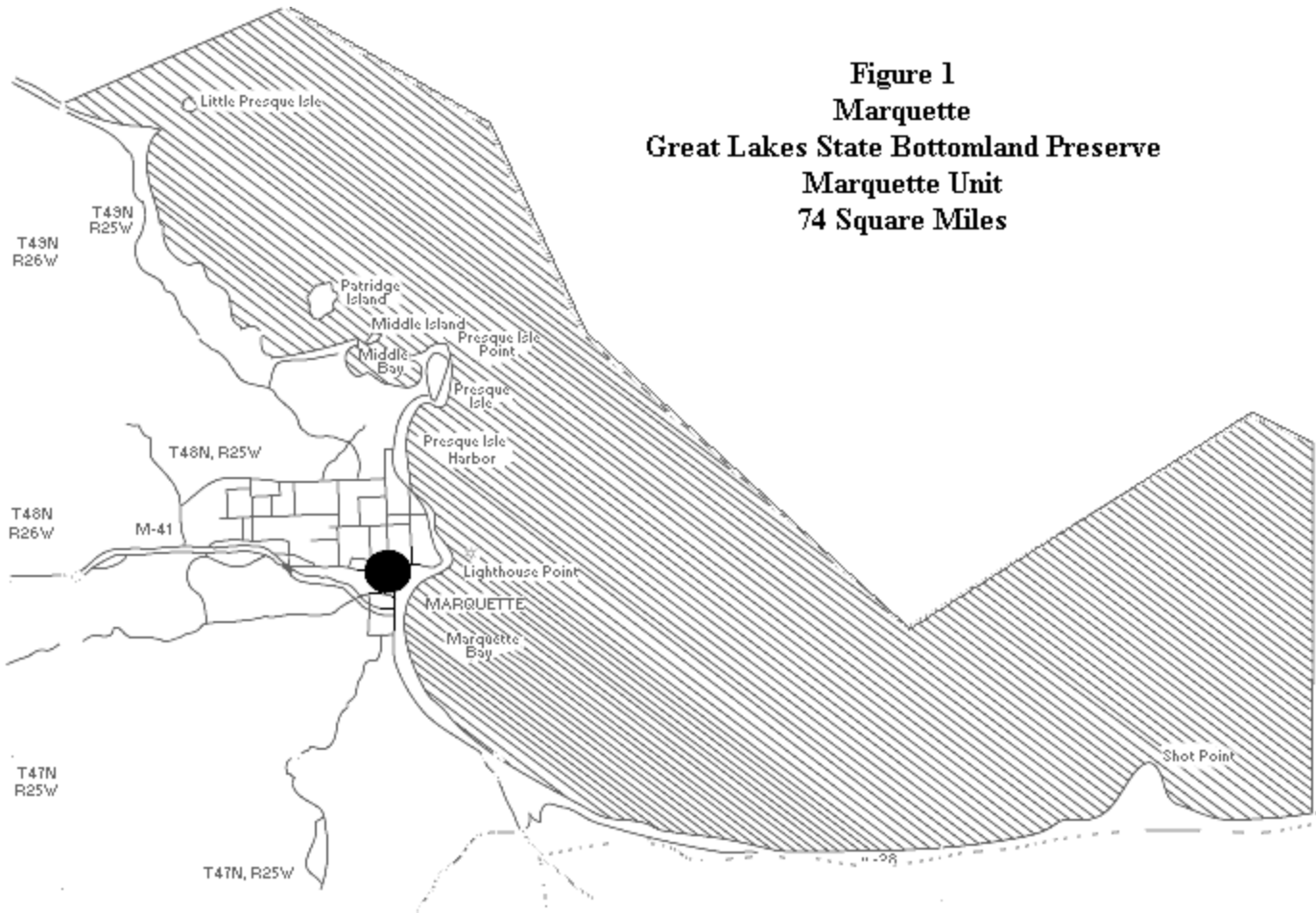

**Figure 2
Marquette
Great Lakes State Bottomland Preserve
Huron Islands Unit
89 Square Miles**

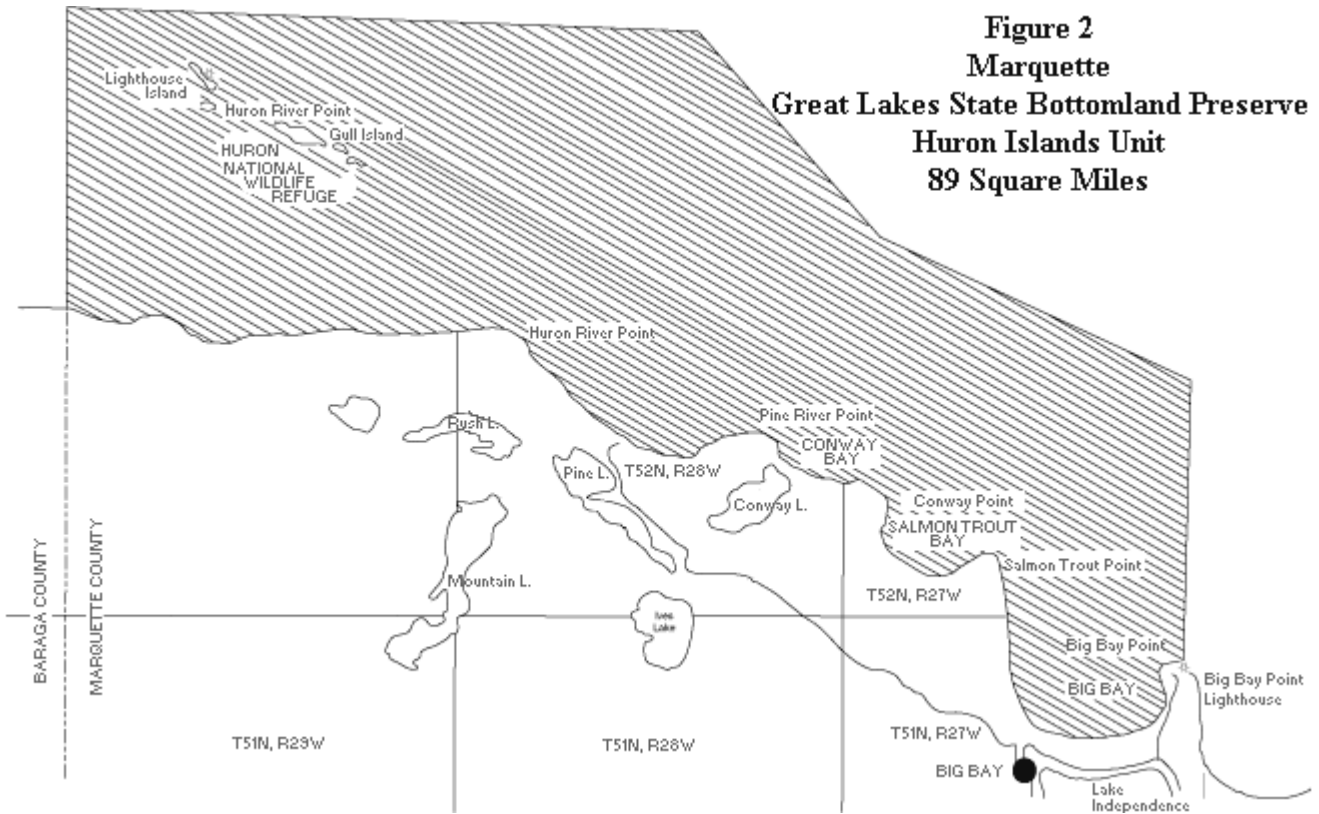

History: 1991 AACs.

R 299.6009 Keweenaw Great Lakes state bottomland preserve; establishment.

Rule 9. (1) The following described area is established as the Keweenaw Great Lakes state bottomland preserve:

A 243-square mile area of Lake Superior bottomland extending upward and including the water surface described as: Beginning at the point where the line between section 25 and section 26 of township 55 north of range 36 west, Houghton County, Michigan, intersects the ordinary high waterline of Lake Superior (elevation 601.5 international Great Lakes datum 1955), approximate latitude 47 degrees 07.8 minutes north longitude 88 degrees 49.7 minutes west; thence due north a distance of 6.91 miles to the point at latitude 47 degrees 13 minutes north longitude 88 degrees 49.7 minutes west; thence northeasterly on a heading of 56 3/4 degrees a distance of 27.20 miles to the point at latitude 47 degrees 26 minutes north longitude 88 degrees 20 minutes west; thence northeasterly on a heading of 73 1/2 degrees a distance of 8.14 miles to the point at latitude 47 degrees 28.5 minutes north longitude 88 degrees 10 minutes west; thence northeasterly on a heading of 81 3/4 degrees a distance of 15.78 miles to the point at latitude 47 degrees 30 minutes north longitude 87 degrees 50 minutes west;

thence southeasterly on a heading of 111 1/2 degrees a distance of 12.59 miles to the point at latitude 47 degrees 26 minutes north longitude 87 degrees 35 minutes west; thence southeasterly on a heading of 126 1/2 degrees a distance of 1.94 miles to the point at latitude 47 degrees 25 minutes north longitude 87 degrees 33 minutes west; thence southwesterly on a heading of 233 1/2 degrees a distance of 1.94 miles to the point at latitude 47 degrees 24 minutes north longitude 87 degrees 33 minutes west; thence southwesterly on a heading of 252 1/2 degrees a distance of 15.56 miles to the point at latitude 47 degrees 20.7 minutes north longitude 87 degrees 54 minutes west; thence due west a distance of 1.57 miles to the point where the line between section 14 and section 15 of township 57 north of range 29 west, Keweenaw County, Michigan, intersects the ordinary high waterline of Lake Superior, approximate latitude 47 degrees 20.7 minutes north longitude 87 degrees 56.3 minutes west; thence northeasterly, northwesterly, northeasterly, easterly, northerly, northwesterly, and southwesterly along the ordinary high waterline to the point of beginning, excluding that part of all islands within the described parcel above the ordinary high waterline.

(2) The Keweenaw Great Lakes state bottomland preserve is illustrated in figure 1 as follows:

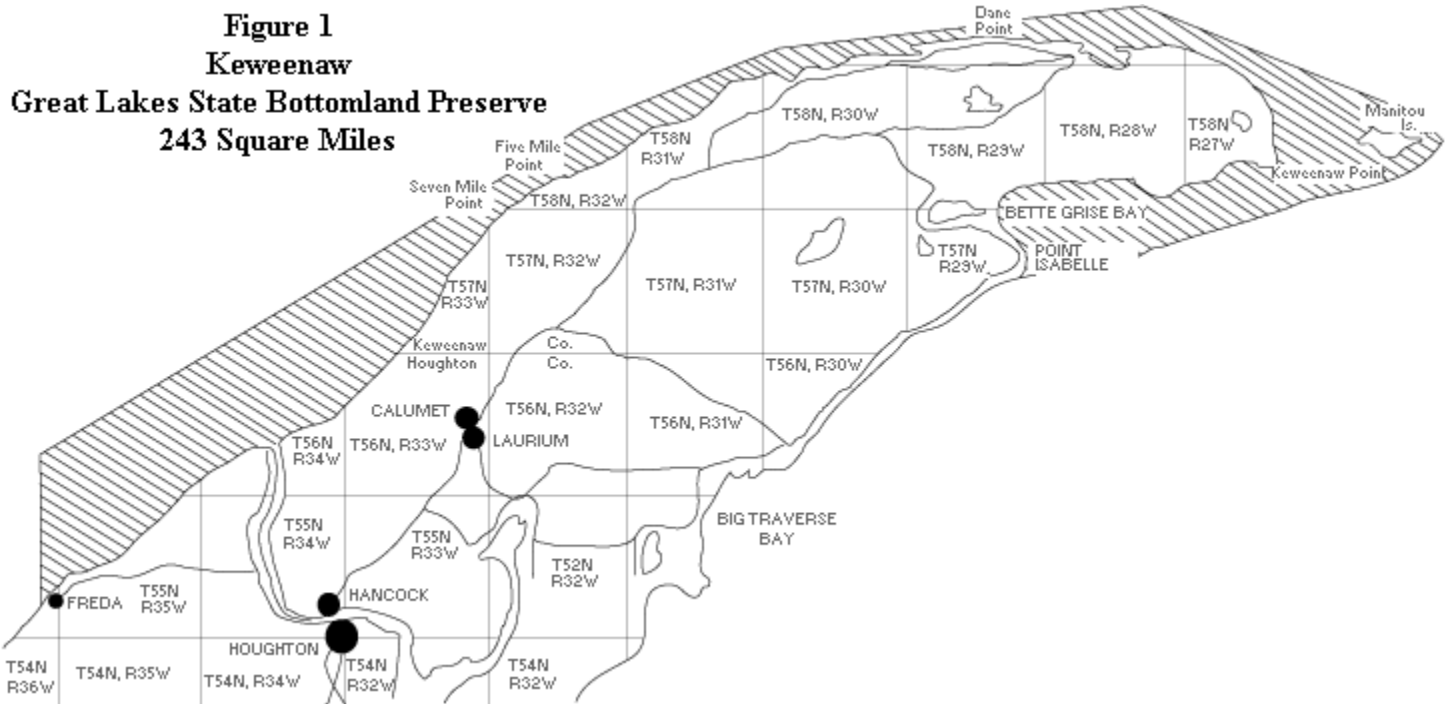

History: 1991 AACCS.

R 299.6010 DeTour Passage Great Lakes state bottomland preserve; establishment.

Rule 10. The following described area is established as the DeTour Passage Great Lakes state bottomland preserve:

(1) A 13.61 - square mile area of Lake Huron, including state-owned public trust bottomlands, extending upward and including the water surface described as: Beginning at the ordinary high water line (elevation 580.5 feet international Great Lakes datum 1985) at the most northerly point of Sweets Point, DeTour township, T42N, R4E, section 21, Chippewa county, thence S 87° 26' 55" E approximately 25,016.54 feet to the ordinary high water line at the most northerly point of Dix point in Drummond township, Drummond island, T42N R5E, section 20, Chippewa county, thence southerly along the ordinary high water line on Drummond island to the most southerly point of point Anderson in Drummond township, Drummond island, T41N R5E, section 17, Chippewa county, thence S 83° 01' 51" W approximately 14,573.82 feet; thence N 59° 38' 16" W approximately 4,158.74 feet to the ordinary high water line on the most southerly point of point DeTour, DeTour township T41N, R4E, section 10, Chippewa county, thence northerly along the ordinary high water mark to the point of beginning, excluding all islands and previously conveyed areas.

(2) The DeTour Passage Great Lakes state bottomland preserve is illustrated in Figure 1 as follows:

DeTour Passage Bottomland Preserve

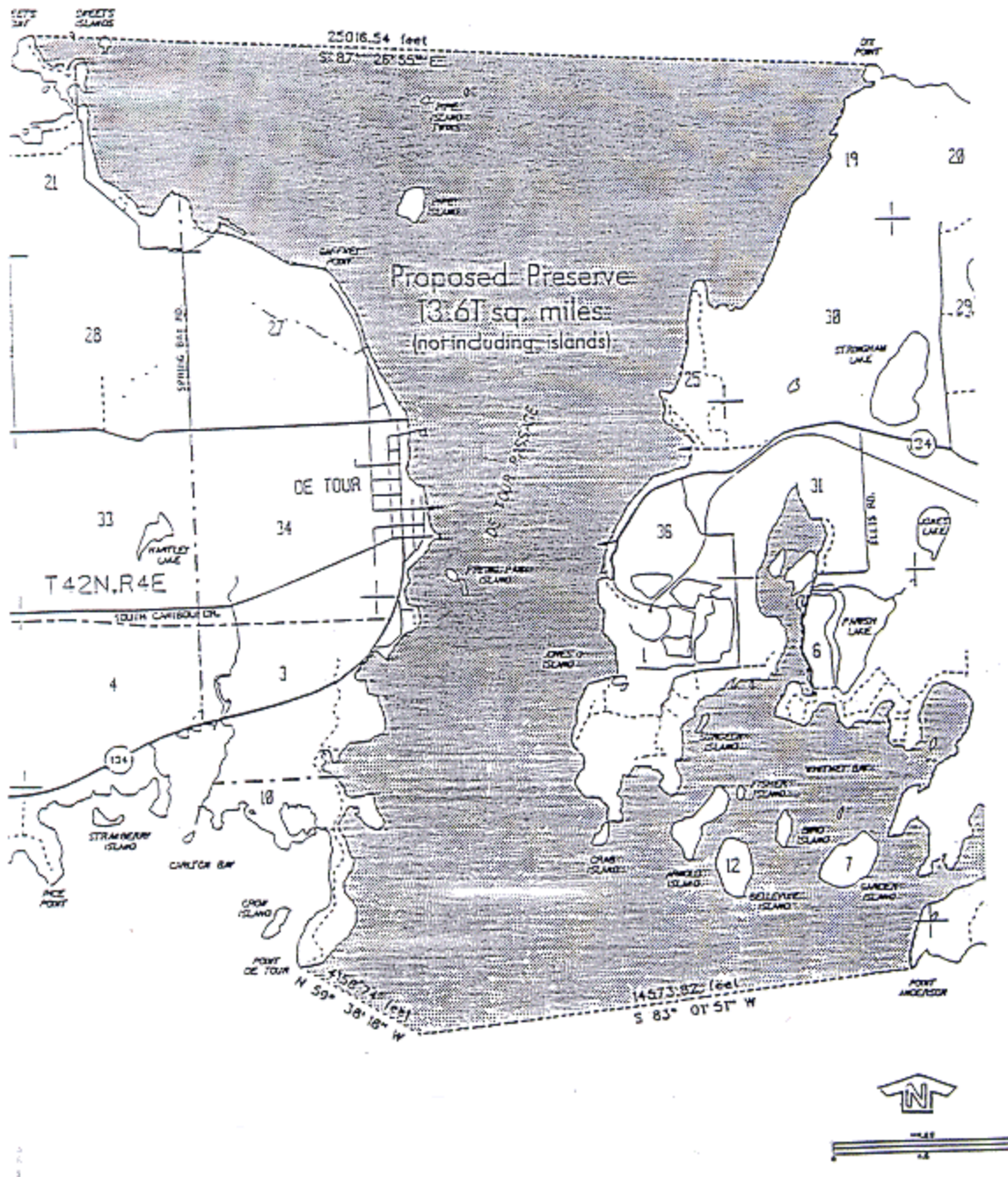

History: 1998-2000 AACS.

R 299.6011 Southwest Michigan Great Lakes state bottomland preserve; establishment.

Rule 11. (1) The following described area is established as the Southwest Michigan Great Lakes state bottomland preserve:

A 370 square mile area of Lake Michigan, including state-owned public trust bottomlands, extending upward and including the water surface described as: Beginning at the point where the east-west quarter line of Section 9, township 5 north, range 16 west, Ottawa County, Michigan, intersects the ordinary high water mark of Lake Michigan (elevation 580.5 feet, international Great Lakes datum 1985), approximate latitude 42 degrees 50 minutes 01 seconds north longitude 86 degrees 12 minutes 41 seconds west; thence westerly on a heading north 88 degrees 52 minutes 35 seconds west 4.02 miles to the point at latitude 42 degrees 50 minutes north longitude 86 degrees 17 minutes 26 seconds west; thence southwesterly on a heading south 03 degrees 54 minutes 08 seconds west 12.51 miles to the point at latitude 42 degrees 39 minutes 08 seconds north longitude 86 degrees 18 minutes 06 seconds west; thence southwesterly on a heading south 16 degrees 44 minutes 13 seconds west 17.42 miles to the point at latitude 42 degrees 24 minutes 32 seconds north longitude 86 degrees 23 minutes 32 seconds west; thence southwesterly on a heading south 28 degrees 54 minutes 23 seconds west 23.01 miles to the point at latitude 42 degrees 06 minutes 47 seconds north longitude 86 degrees 35 minutes 57 seconds west; thence southwesterly on a heading south 25 degrees 15 minutes 44 seconds west 14.87 miles to the point at latitude 41 degrees 54 minutes 57 seconds north longitude 86 degrees 42 minutes 55 seconds west; thence southeasterly on a heading south 47 degrees 05 minutes 35 seconds 4.65 miles to a point where the south line of Section 9, township 7 south, range 20 west, Berrien County, intersects the ordinary high water mark of Lake Michigan (elevation 580.5 feet, international Great Lakes datum 1985), thence northerly, and northeasterly along the ordinary high water mark to the point of beginning.

(2) The Southwest Michigan Great Lakes state bottomland preserve is illustrated in Figure 1 as follows:

**** For Map see attached file labeled "Figures" ****

History: 1999 AACS.

R 299.6012 Grand Traverse Bay Great Lakes state bottomland preserve; establishment.

Rule 12. (1) The following described area is established as the Grand Traverse Bay Great Lakes state bottomland preserve:

An area of Lake Michigan bottomlands including the water surface described as: beginning at the point where the northernmost portion of Cathead Point, Leelanau County intersects the Ordinary High Water Mark (OHWM) of Lake Michigan (approximately 45°11'15"N, -85°37'04"W), thence northeasterly to a point in Lake Michigan lying at 45°13'54"N, -85°33'14"W (north of Lighthouse Point, Leelanau

County) thence proceeding easterly along latitude line 45°13'54"N until it intersects the OHWM in Charlevoix County (approximately 45°13'54"N, -85°23'19"W, north of Norwood), thence along the OHWM of Grand Traverse Bay generally southerly, westerly, and northerly, to the point of beginning, including all of the West and East arm of Grand Traverse Bay, excluding all islands above the ordinary high waterline of Lake Michigan and previously conveyed areas, containing 295 square miles, more or less.

History: 2008 AACS.

R 299.6013 West Michigan Great Lakes state bottomland preserve; establishment.

Rule 13. (1) The following described area is established as the West Michigan Great Lakes state bottomland preserve:

(a) An area of Lake Michigan bottomlands including the water surface described as: beginning north of the Big Sable Lighthouse at a point on the shoreline N44° 04.900' / W086° 29.430' and following the natural ordinary high-water mark southerly to a point on the shoreline N42° 50.017' / W086° 12.683', thence due west 4 statute miles, thence northerly parallel to the natural ordinary high-water mark to a point 4 statute miles due west of said shoreline point N44° 04.900' / W086° 29.430', thence due east 4 statute miles to the point of beginning, containing 345 square miles, more or less.

History: 2012 AACS.